

SCCQ Chinchilla (Illoura Village) new aged care home

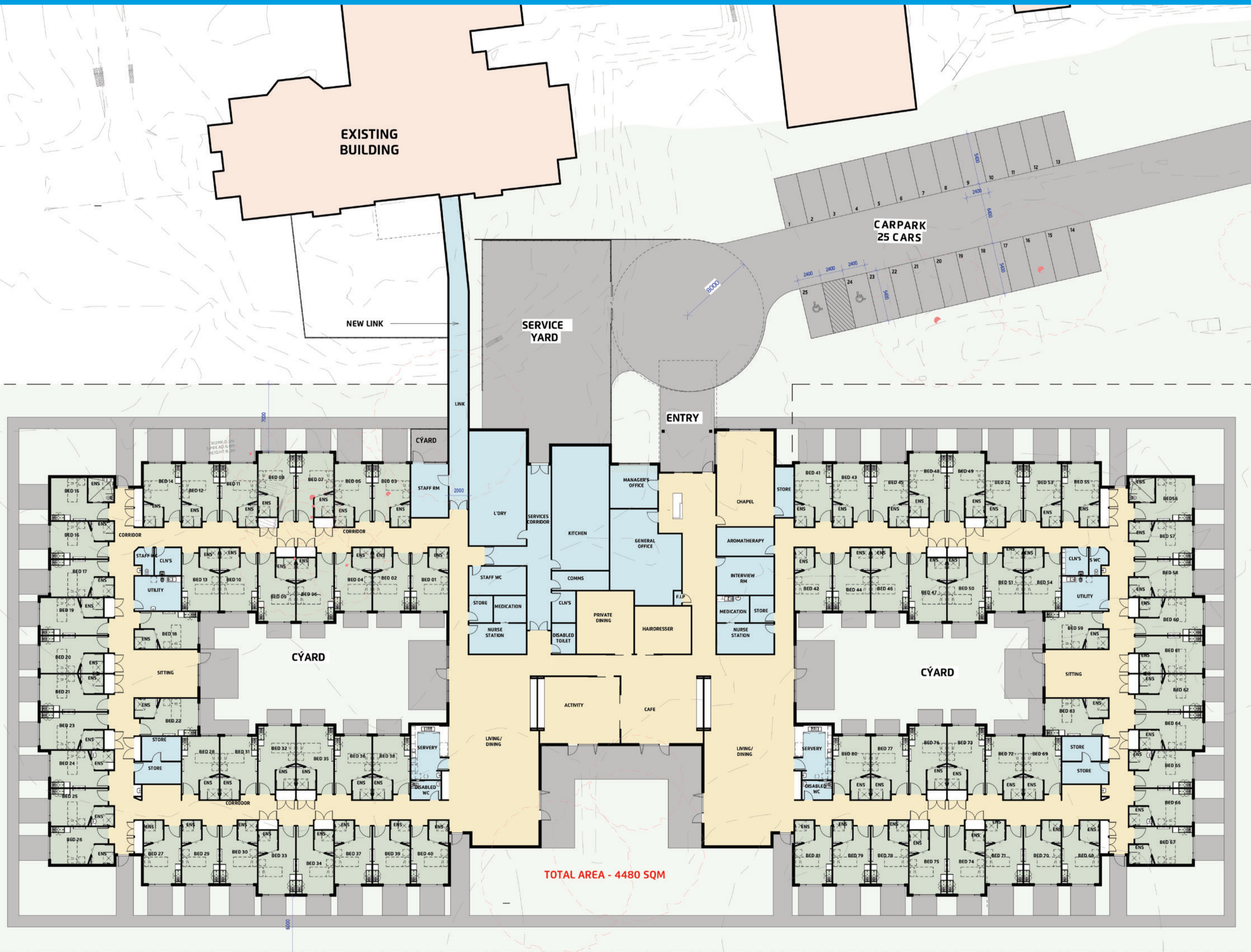

Resident common areas and hair salon, images are indicative

SCCQ Chinchilla (Illoura Village) Master Plan

Refurbishment of Calma Court to accommodate up to 23 residents who need dementia-specific care and support

Dedicated Education and Training Hub to help skill and grow a local pool of qualified allied health and nursing professionals undertaking clinical placements



Indicative only

New aged care home to accommodate up to 81 residents and offer respite care and support

Community Centre to include health & wellness, allied health, home care and day respite services