

OUR STRATEGIC PARTNERS

'Through collaboration and partnerships we can offer the region an innovative and sustainable model for the future which creates jobs and keeps communities and families connected.'



We partner with the Toowoomba Surat Basin Enterprise an independent, member-driven economic development organisation linking business, workforce and investment opportunities across Toowoomba, Western Downs, Maranoa and surrounding areas. Together, our goal is to connect and strengthen connections between the health industry and the education sector.



We are committed to partnering with the Western Downs Regional Council (WDRC) to help create communities where best lives are lived. Together we have enabled people to age in place where they have established connections and a sense of belonging. In April, 2022 we worked collaboratively to transition WDRC aged care services to the SCCQ family.



We have partnered with Southern Queensland Rural Health (SQRH) who support nursing, midwifery, allied health students and health professionals to develop a high quality and highly skilled workforce across regional, rural and remote Southern Queensland.

We have entered into an MOU with SQRH and our goal is to skill and grow a local pool of qualified allied health and nursing professionals. This is part of a formal collaboration led by Associate Professor Geoff Argus between The University of Queensland, University of Southern Queensland and Darling Downs Health and South West Hospital and Health Service.

Currently Illoura Village supports clinical placements and our new dedicated Education and Training Hub will help us to create additional education and training opportunities.



We are working in collaboration with Goondir Health whose vision is to improve the health and well-being of Aboriginal and Torres Strait Islander people to a standard at least equal to that of the wider Australian community by providing holistic health care and medical services that meet best practice standards.

In Stage 2 of our Master Plan, our redevelopment will accommodate and support Goondir Health Services and help to improve access to integrated allied health, community and wellness services for the Aboriginal and Torres Strait Islander community in South East and South West Queensland.

OUR SERVICES

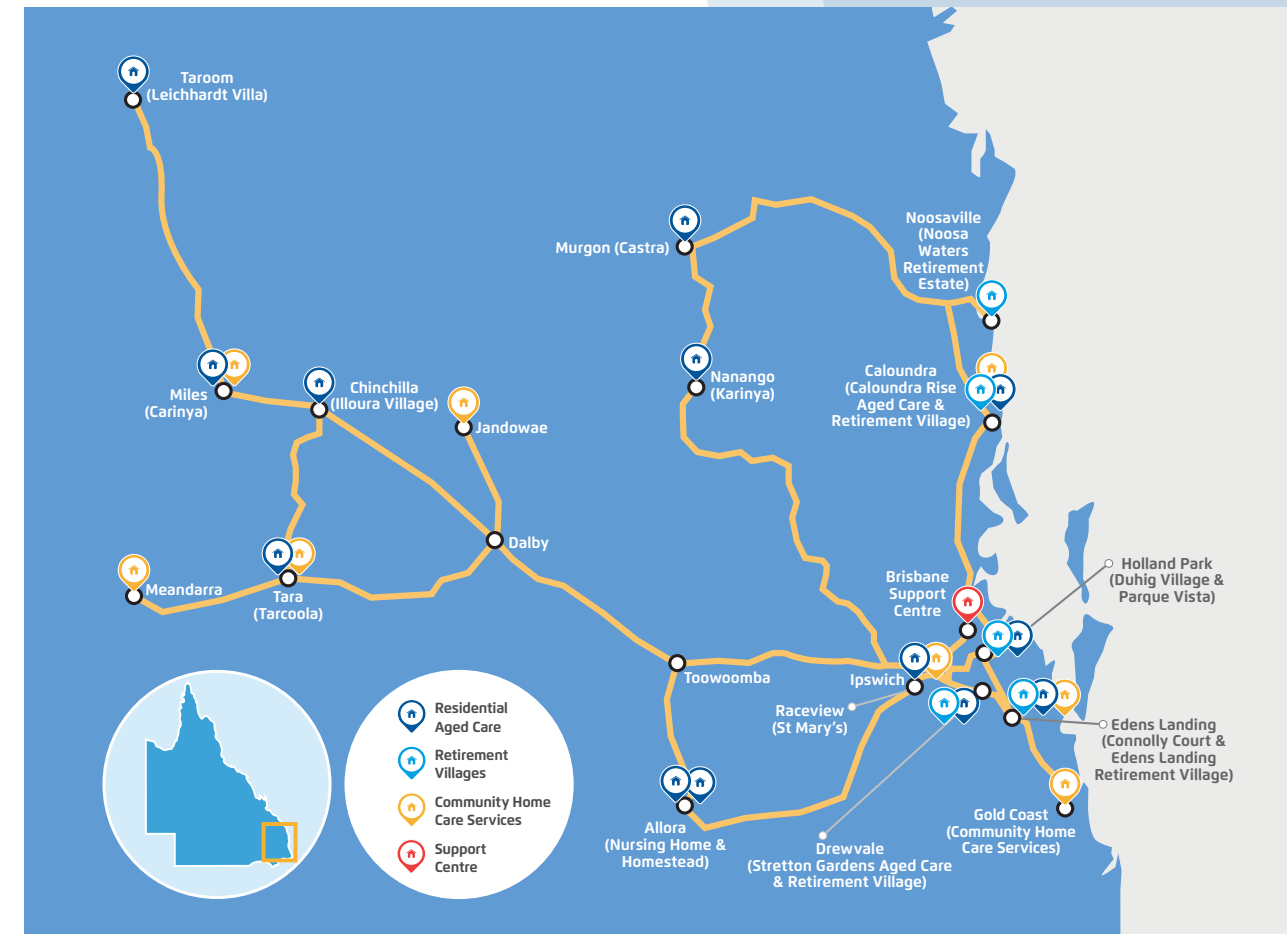

SUPPORT OUR VISION

If you would like to be involved, please connect with us. To stay informed about this exciting project, register for our regular project updates. Expressions of interest about construction, employment and training opportunities are welcome.

ABOUT SCCQ

Southern Cross Care Queensland (SCCQ) is a not-for-profit organisation established by the Knights of the Southern Cross, a Catholic service organisation, more than 40 years ago. They saw a need to provide compassionate care and inclusive service to some of the most vulnerable, the ageing population, in the community.

CONTACT US

Southern Cross Care Illoura Village

- 24-30 Zeller Street, Chinchilla Q 4413
- westerndowns@sccqld.com.au
- 1300 349 199

SCCQ Support Centre

- 2078 Logan Road, Upper Mt Gravatt
- enquiries@sccqld.com.au
- 1800 899 300

sccqld.com.au



OUR VISION IS TO GROW COMMUNITIES WHERE BEST LIVES ARE LIVED.

SOUTHERN CROSS CARE QUEENSLAND (SCCQ) ILLOURA VILLAGE, CHINCHILLA

**REDEVELOPMENT & EXPANSION
DECEMBER 2022**



After many months of careful planning, consultation and navigating a COVID-19 environment, it is incredibly exciting to see the redevelopment and expansion of our much-loved Illoura Village ready to progress to construction.

The first stage of our Vision and master plan for Chinchilla and the region includes building a new purpose-built contemporary aged care home to accommodate up to 81 residents, and a new training, education and community centre.

Serving the needs of our residents and clients with compassion and care is, and always has been, at the heart of what we do. How we best serve and deliver our services continues to evolve and is shaped by our environment, client and resident needs and the feedback from the people we serve.

Our new Illoura Village will boost access to high quality aged care services to the local community, so older people can age in a place where they have established connections and a sense of belonging.

At Southern Cross Care Queensland, our heart is in serving and supporting rural and remote Queensland communities, and we collaborate with, and take guidance from, industry and

community stakeholders who are willing and able to explore innovative, sustainable models of community and help us to best serve those who place their trust in us.

We believe that it is through collaboration and partnerships that we can offer the region an innovative and sustainable model for the future which creates jobs and keeps communities and families connected.

In the future, our vision for Chinchilla and the surrounding regions is to build aged-care communities that offer an integrated mix of housing co-located with aged care, community services (day respite/ home care) and education, to best meet the needs of the whole community.

We're looking forward to a bright future in Chinchilla and surrounding regions, where residents, families and the community can live their best lives.

Yours in service,

Jason Eldering, Chief Executive Officer

ILLOURA VILLAGE MASTER PLAN

SCCQ's vision and master plan for Illoura Village is to build aged-care communities that offer an integrated mix of housing co-located with aged care, community services and education and training opportunities to best meet the needs of Chinchilla and the surrounding region.

Refurbishment of Calma Court to accommodate up to 23 residents who need dementia-specific care and support



Dedicated Education and Training Hub to help skill and grow a local pool of qualified allied health and nursing professionals undertaking clinical placements

New aged care home to accommodate up to 81 residents and offer respite care and support

Community Centre to include health & wellness, allied health, home care and day respite services

STAGE 1: ILLOURA VILLAGE, REDEVELOPMENT AND EXPANSION

Our new aged care home will offer a contemporary, comfortable and home-like environment, purpose-built to meet the needs of our residents who need clinical care and support as they age and their needs change. It replaces two existing facilities which currently accommodate up to 66 residents, who will benefit greatly from the upgrade.

The new home spans two wings and comprises 81 single bedrooms each with an ensuite. Residents in each wing will have access to a dedicated internal courtyard, sitting, living and dining areas and a nurse station is situated in close proximity to common areas and resident rooms.

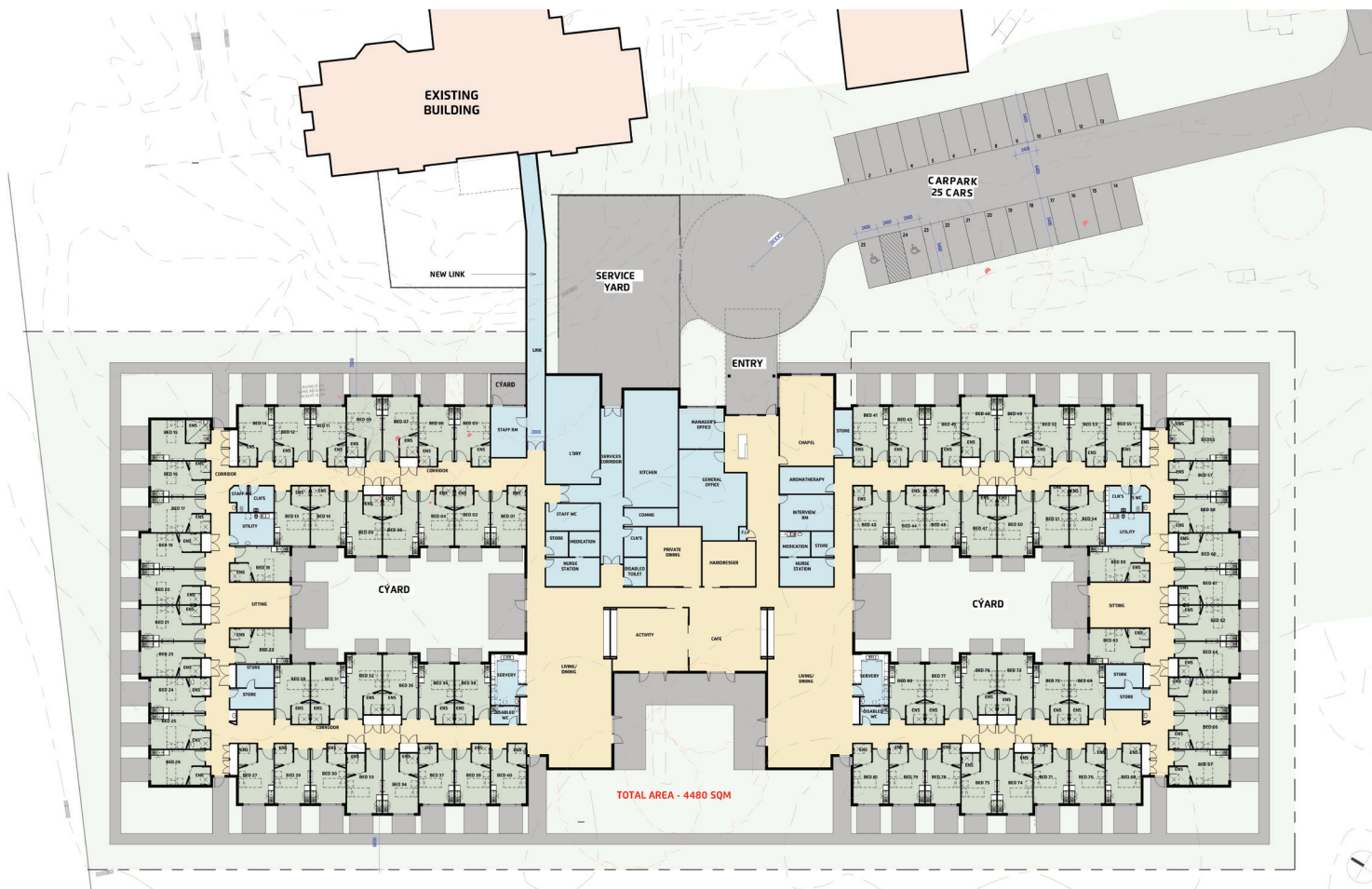

FACILITIES AND AMENITIES

- 81 bedrooms each with an ensuite
- spacious internal courtyards
- comfortable sitting & lounge areas
- generous lifestyle activity space
- dining room for private functions
- dining room for common use
- meeting room for families and loved ones
- therapy & treatment room
- caterer's kitchen to service the whole home
- laundry, storage & utility spaces
- chapel
- café
- hairdressing salon
- car park



Resident common areas and hair salon, images are indicative

PROJECT DETAILS

Planned construction commencement	Mid-2023
Planned construction completion	December 2024
Builder	Integral Constructions
Project Cost	\$28.35 million – new 81-bed home \$3 million – Training & Education Centre
Project Funders	Southern Cross Care Queensland Australian Government, Department of Health
Project Manager	Castalia Group
Architect	Smith + tracey architects
Interior Design	MDC Interior Design
Civil & Structural Engineers	Alta Civil & Structural Engineers